

# INSTALLATION INSTRUCTIONS

## SERIES #1374 3-LITE SINGLE SLIDER LIFTOUT WINDOW

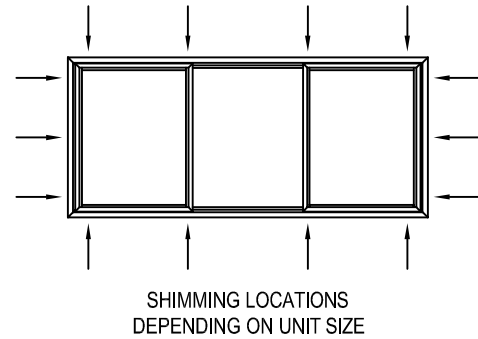
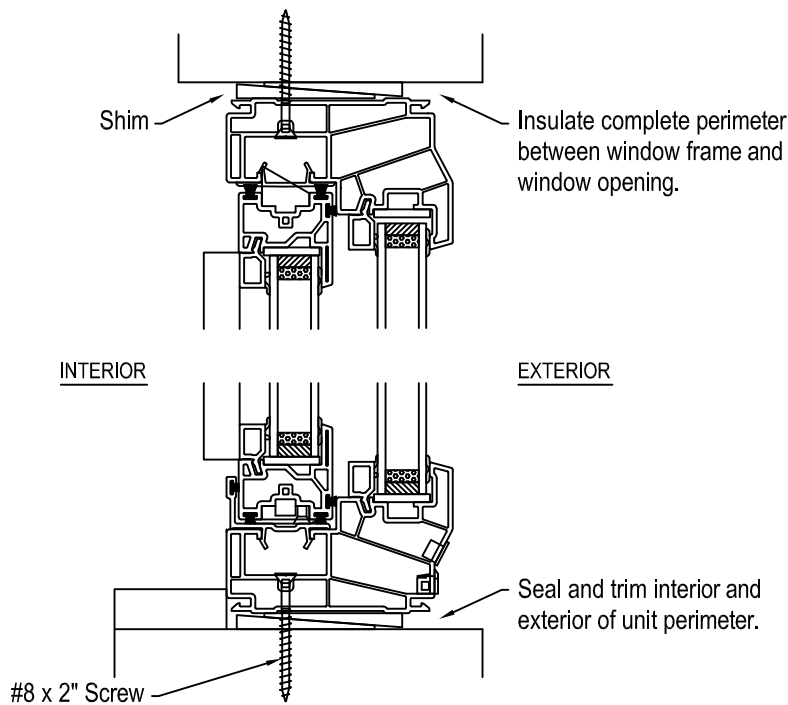

- 1.) Do not cut center banding.
- 2.) Check rough opening to ensure that the window unit will fit. Rough opening should be 1/4" to 1/2" larger than the window, both horizontally and vertically.
- 3.) Place window in opening.
- 4.) Unlock window, and slide operating sashes to center.
- 5.) Locate side jamb covers (snap in covers, with weatherstripping at each end of the window) and remove them by inserting a sharp chisel and prying.
- 6.) Shim side jamb frame members 4" from top and bottom and approximately 16" intervals. Shims should be firm but not tight enough to cause the jambs to bow. Check level, plumb, and squareness of frame and adjust shims if necessary.
- 7.) Install screws through pockets of the frame where jamb covers were removed, at each shim location, being careful not to bow frame. Suggest using #8 x 2" screws, (screw length is dependent upon frame structure, screw length must be of sufficient length to securely anchor unit in opening).
- 8.) Close sashes and lock window.
- 9.) Shim sill and head frame members, at sash meeting stile locations until frame members are level. Place additional shims 4" from each end and at 16" intervals. To ensure a proper seal the gap between sash and frame should be the same at the midpoint as at either end, of each sash.
- 10.) Cut and remove center banding.
- 11.) Remove both operating sash.
- 12.) Remove interior sill cover (snap in cover with weatherstripping), by prying with a sharp chisel.
- 13.) At head and sill shim locations, fasten unit through the frame using #8 x 2" screws, (screw length must be of sufficient length to securely anchor unit in opening).
- 14.) **IMPORTANT:** When anchoring unit through sill, place screws at shim locations and seal screw heads with "GE 2800" silicone or equivalent.
- 15.) Snap interior sill cover back into frame.
- 16.) Snap side jamb covers back into appropriate frame members.
- 17.) Place both sash back into frame and check that the gap between sash and frame remain constant over the entire width of the window. The window unit can be readjusted by loosening the screws, leveling, shimming and re-tightening them as required.
- 18.) Insulate between the window frame and the rough opening, ensuring all voids are filled. Caution must be exercised as not to over pack the insulation causing unit frame to distort.
- 19.) Seal and trim window inside and out to suit application